

# Screw pumps - PXFCR

For lubrication of cryogenic compressor.

Closed circuit with high suction pressure.

Admissible delivery pressure (continuous) = 30 bar at 1800 rpm.

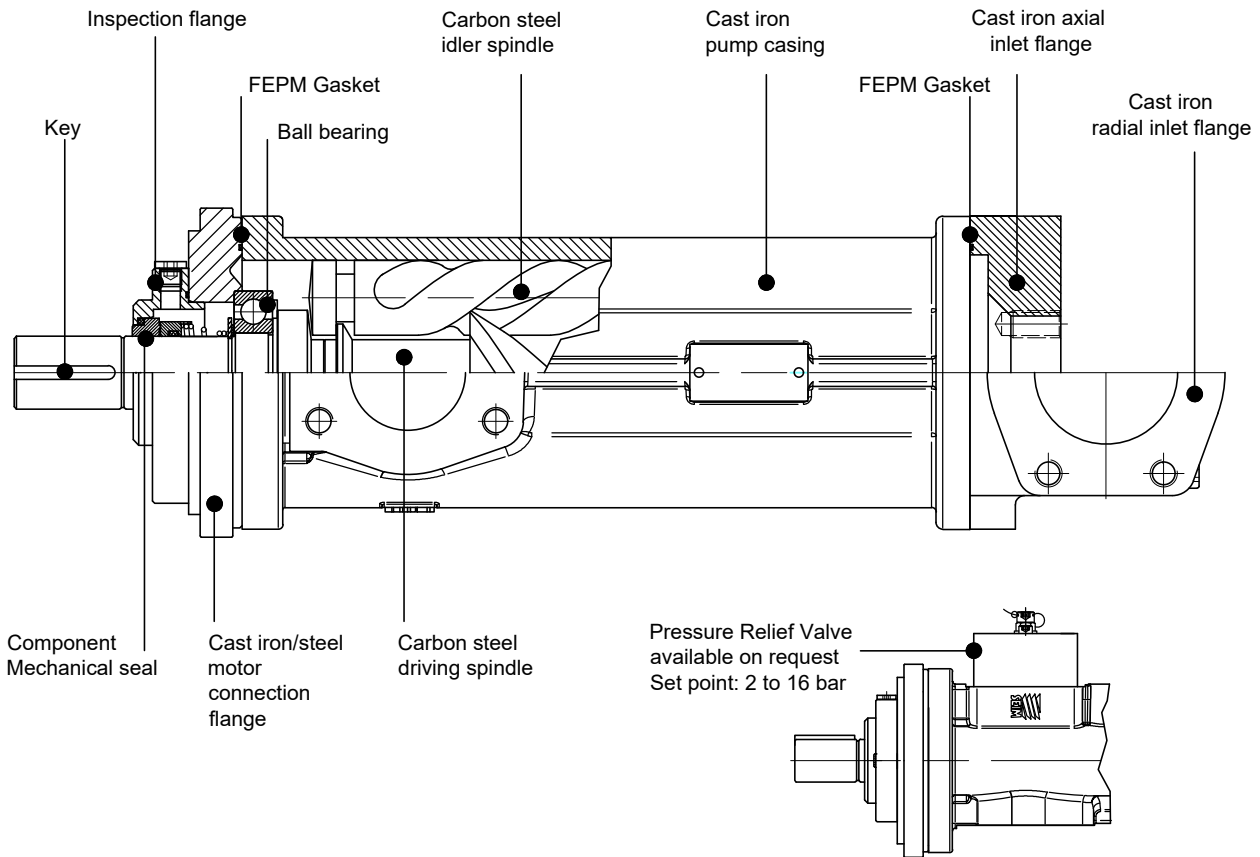
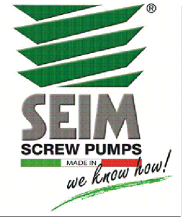

SD - STE - PXFCR - ENG 11-24 - 2

## Functional characteristic standard version

<b>Delivery flow</b>	80 to 570 l/min (21 to 150 USGPM)	
<b>Admissible delivery pressure*</b>	up to 30 bar (435 psi)	
<b>Admissible suction pressure **</b>	up to 30 bar (435 psi)	For different values contact SEIM
<b>Kinematic viscosity</b>	10 to 400 cSt	For different values contact SEIM
<b>Admissible temperature **</b>	0 to 120°C (32 to 248°F)	For different values contact SEIM
<b>Driving speed ***</b>	750 to 1800 rpm	
<b>Average noise level</b>	53 - 60 dB(A) at 1800 rpm according to pump dimension	
<b>Recommended filtration</b>	ISO4406 19 / 16 - NAS 10	
<b>Direction of rotation</b>	clockwise, as seen from the driving side	

\* Reduced pressure limit apply due to fluid viscosity and driving speed.

\*\* Pressure and temperature at inlet shall be properly driven in order to avoid cavitation.  
Consult performance charts for individual pump size performance.

\*\*\* Higher driving speed can apply, with special mechanical seal; refer to table 2 for the assessment

*For different functional characteristics, please contact our sales department.*

# Screw pumps - PXFCR

For lubrication of cryogenic compressor.

Closed circuit with high suction pressure.

Admissible delivery pressure (continuous) = 30 bar at 1800 rpm.



OPT.1  
RADIAL  
INLET  
FLANGE

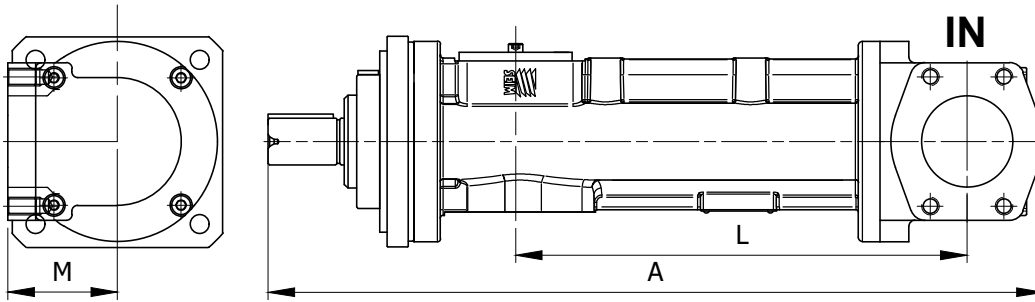

OPT.2  
AXIAL  
INLET  
FLANGE

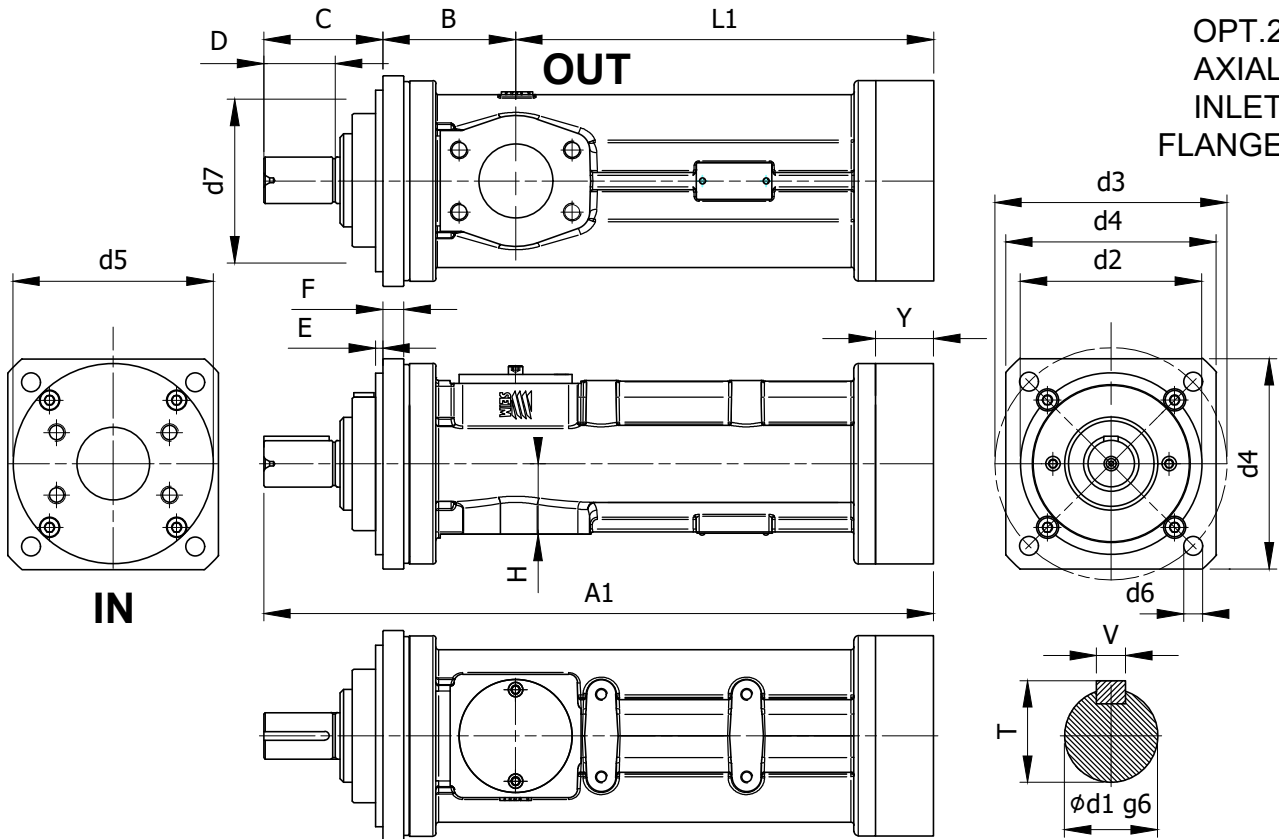

SD - STE - PXFCR - ENG 11-24 - 2

## Dimensional chart (mm)

MODELLO	A	A1	B	C	D	E	F	H	L	L1	M	SAE 3000		T	V	Inlet flange adjustable to 90° and 180°									
												IN	OUT			d1	d2	d3	d4	d5	d6	Y			
PXFCR032#4..	419	364	88	75	40	5	15	52	211	201	60	2"	1 1/2"	21,5	6	19	125	160	145	120	13	45			
PXFCR040#4..	448	393	88	75	40	5	15	52	240	230	60	2"	1 1/2"	21,5	6	19	125	160	145	120	13	45			
PXFCR045#4..	494	432	91,5	81	45	5	15	48,5	269	259	75,5	2 1/2"	2"	35	10	32	125	160	145	138	13	50			
PXFCR055#4..	534	472	91,5	82	45	5	15	48,5	308	298	75,5	2 1/2"	2"	35	10	32	125	160	145	138	13	50			
PXFCR060#4..	631	527	88	84	45	5	18	73,5	386	355	100	4"	2 1/2"	35	10	32	160	200	195	174	18	50			
PXFCR072#4..	718	613	88	101	58	5	18	73,5	455	424	100	4"	2 1/2"	35	10	32	160	200	195	174	18	50			

SEIM srl  
Via A. Volta 17  
20090 Cusago (MI) ITALY  
Tel. (+39) 02.90.39.21.1  
Fax. (+39) 02.90.39.21.41  
e-mail: [seim@seim.it](mailto:seim@seim.it)

Ask pumps drawing for all dimensional details.

[www.seim.it](http://www.seim.it)

SEIM reserves the right to introduce dimensional changes or variation to the products of this technical data.

# Screw pumps - PXFCR

For lubrication of cryogenic compressor.  
 Closed circuit with high suction pressure.  
 Admissible delivery pressure (continuous) = 30 bar at 1800 rpm.



## Appendix

VISCOSITY	FILTER MESH
< 5 cSt	60 mesh
< 10 cSt	40 mesh
< 20 cSt	20 mesh
< 200 cSt	Perforation 1/8"
< 500 cSt	Perforation 3/16"
> 500 cSt	Perforation 1/4"

Table 1

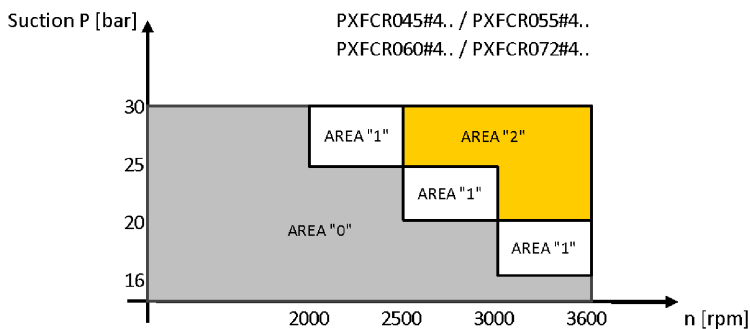
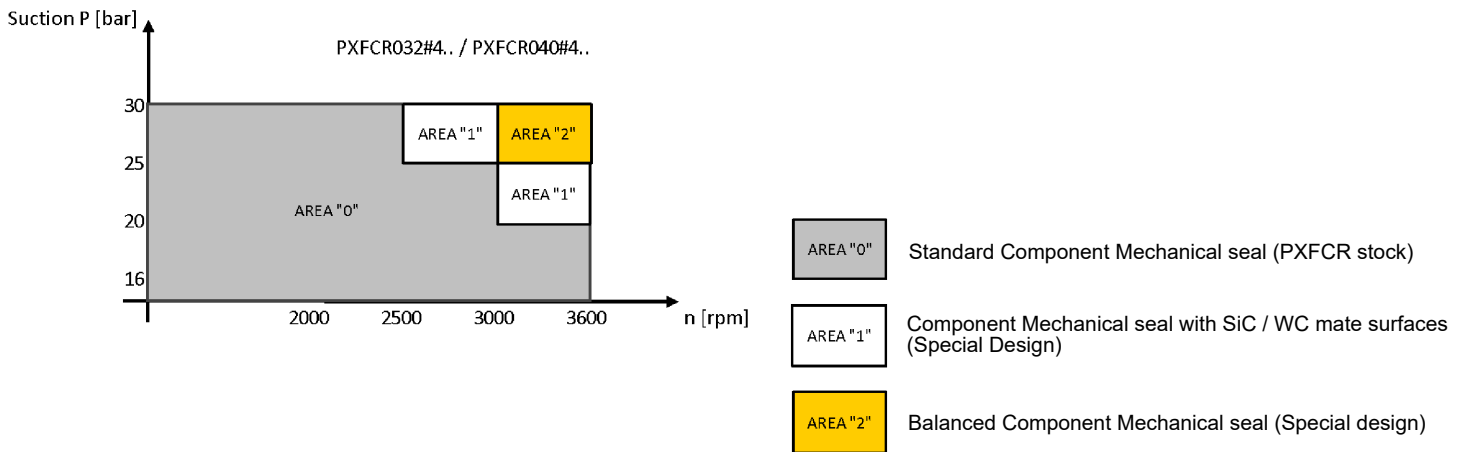

Table 2 - P vs n Ratio, for mechanical seal selection - REFER TO SEIM